



1 South View, Bamford, Hope Valley, S33 0BL

Saxton Mee

# 1 South View

## Bamford

Offers Around

# £240,000

This four-bedroom stone-built cottage, arranged over three floors, is nestled in the highly desirable Peak District village of Bamford, offering a rare opportunity for buyers seeking a property with scope to personalise.

Set in a peaceful location, the home presents an exciting blank canvas, ideal for those looking to create a bespoke residence tailored to their own style and requirements. The property enjoys the benefit of excellent local amenities, sought-after primary and secondary school catchments, convenient transport links, a local railway station and easy access to major commercial centres.

The accommodation includes a fitted kitchen and living room on the ground floor.

The first floor provides two generously sized bedrooms and a bathroom, while the second floor features two additional bedrooms, both with Velux windows

Externally, there are low-maintenance gardens to the front and rear, with further potential to create off-road parking, subject to the necessary planning permissions. Exterior store.

Offered for sale with no upward chain, this is an excellent opportunity to acquire a characterful home with fantastic potential in one of the Peak District's most sought-after villages.



- Stunning Views
- Popular Peak District Village
- Excellent Local Amenities
- Highly Regarded School Catchment
- Local Rail Links
- Direct Access To Outdoor Pursuits
- Potential To Complete To Individual Specifications
- No Upward Chain
- EPC: TBC
- Viewings: Hathersage Office





# 1 South View

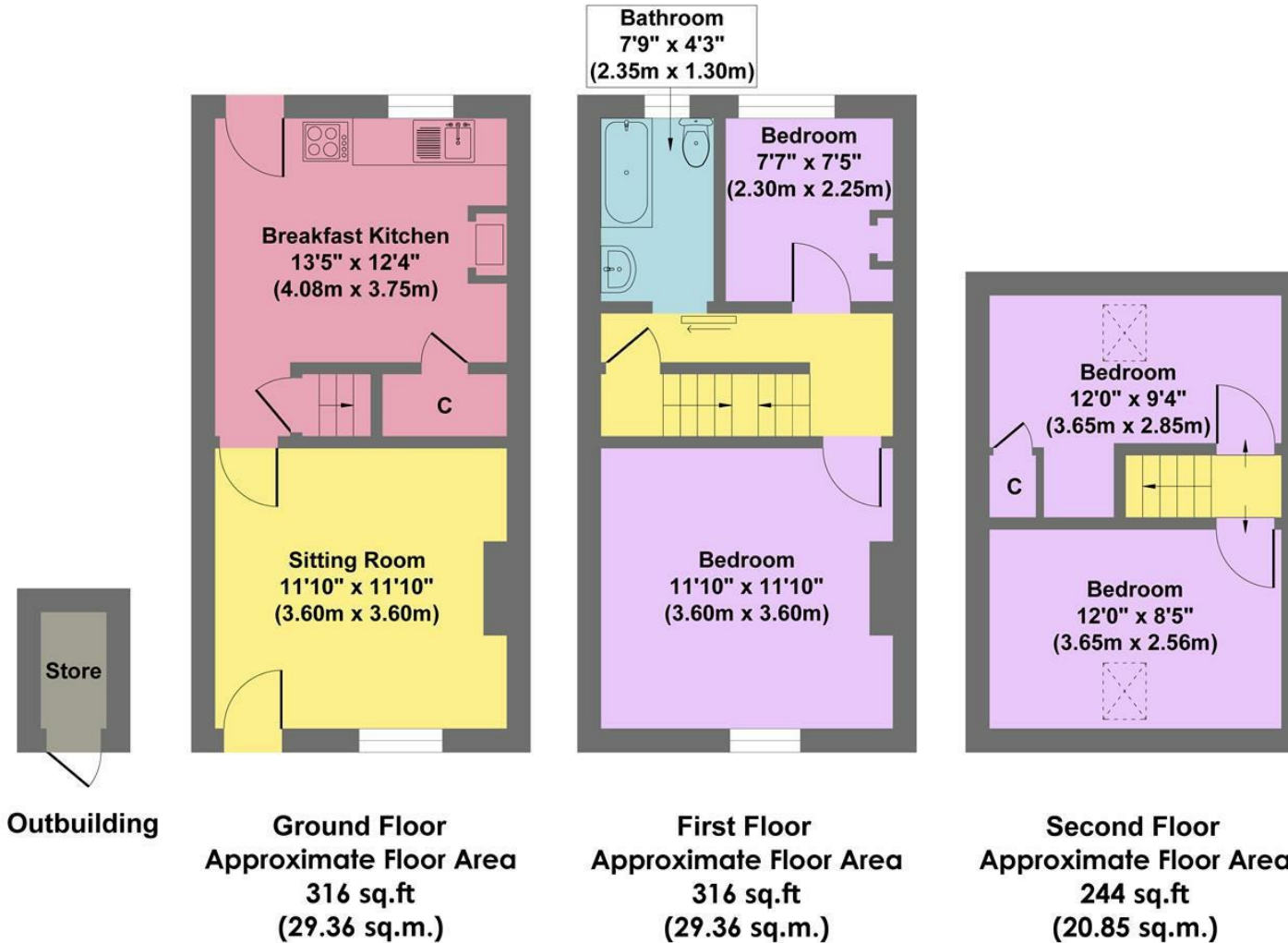

**Approx. Gross Internal Floor Area 876 sq.ft / 79.57 sq.m**

Illustration for identification purposes only. Measurements are approximate, not to scale

While we endeavour to make our sales particulars fair, accurate and reliable, they are only a general guide to the property and, accordingly, if there is any point, which is of particular importance to you, please contact the relevant office. The Agents have not tested any apparatus, equipment, fittings or services and so cannot verify they are in working order. The buyer is advised to obtain verification. Please note all the measurement details are approximate and should not be relied upon as exact. All plans, floor plans and maps are for guidance purposes only and are not to scale. Under no circumstances should they be relied upon as exact or for use in planning carpets and other such fixtures, fittings or furnishings. YOUR HOME IS AT RISK IF YOU DO NOT KEEP UP REPAYMENTS ON A MORTGAGE OR OTHER LOAN SECURED ON IT. 'A Life Assurance policy may be requested.' 'Written Quotations of credit terms available on request.'

Banner Cross  
T: 0114 268 3241  
E: [bannercross@saxtonmee.co.uk](mailto:bannercross@saxtonmee.co.uk)  
[www.saxtonmee.co.uk](http://www.saxtonmee.co.uk)

Hathersage  
T: 01433 650009  
E: [hathersage@saxtonmee.co.uk](mailto:hathersage@saxtonmee.co.uk)

Bakewell  
T: 01629 815307  
E: [bakewell@saxtonmee.co.uk](mailto:bakewell@saxtonmee.co.uk)

Matlock  
T: 01629 828250  
E: [matlock@saxtonmee.co.uk](mailto:matlock@saxtonmee.co.uk)

